

THE RIVER DISTRICT

JOINT APPLICATION

CASCADE, ID

PAGE 1 OF 6

COVER SHEET

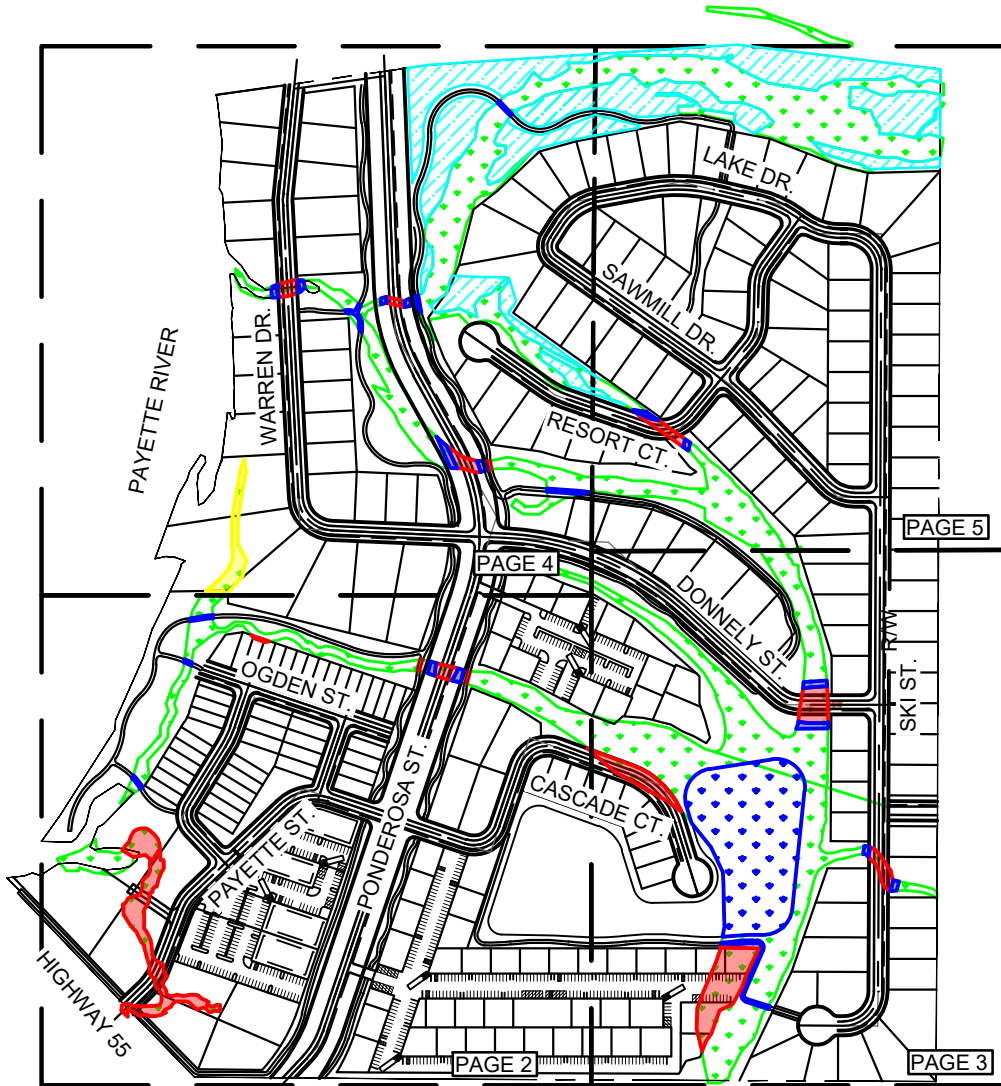

LEGEND:

PERMANENT	
TEMPORARY	
MINIMIZED	
WETLAND	
POND WETLAND	
POTENTIAL MITIGATION AREA	

TOTALS AND DISTURBANCES:

PERMANENT	1.59 AC
TEMPORARY	0.32 AC
MINIMIZED	0.19 AC
POND WETLANDS	2.37 AC
TOTAL WETLANDS	15.7 AC
WETLANDS AVOIDED	13.8 AC
POTENTIAL MITIGATION AREA	5.02 AC

NOTE: PATHWAY FROM LAKE DR. TO PONDEROSA ST. IS TO BE A GRAVEL PATHWAY

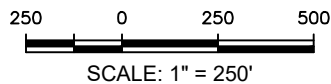

T-O ENGINEERS

2471 S. TITANIUM PLACE
MERIDIAN, IDAHO 83642-6703

PHONE: (208) 323-2288

WWW.TO-ENGINEERS.COM

E-FILE: 190100-404 SHEETS.dwg

DATE: 1/6/20

JOB: 190100

THE RIVER DISTRICT

JOINT APPLICATION

CASCADE, ID

PAGE 2 OF 6

PAGE 2 (SW CORNER)

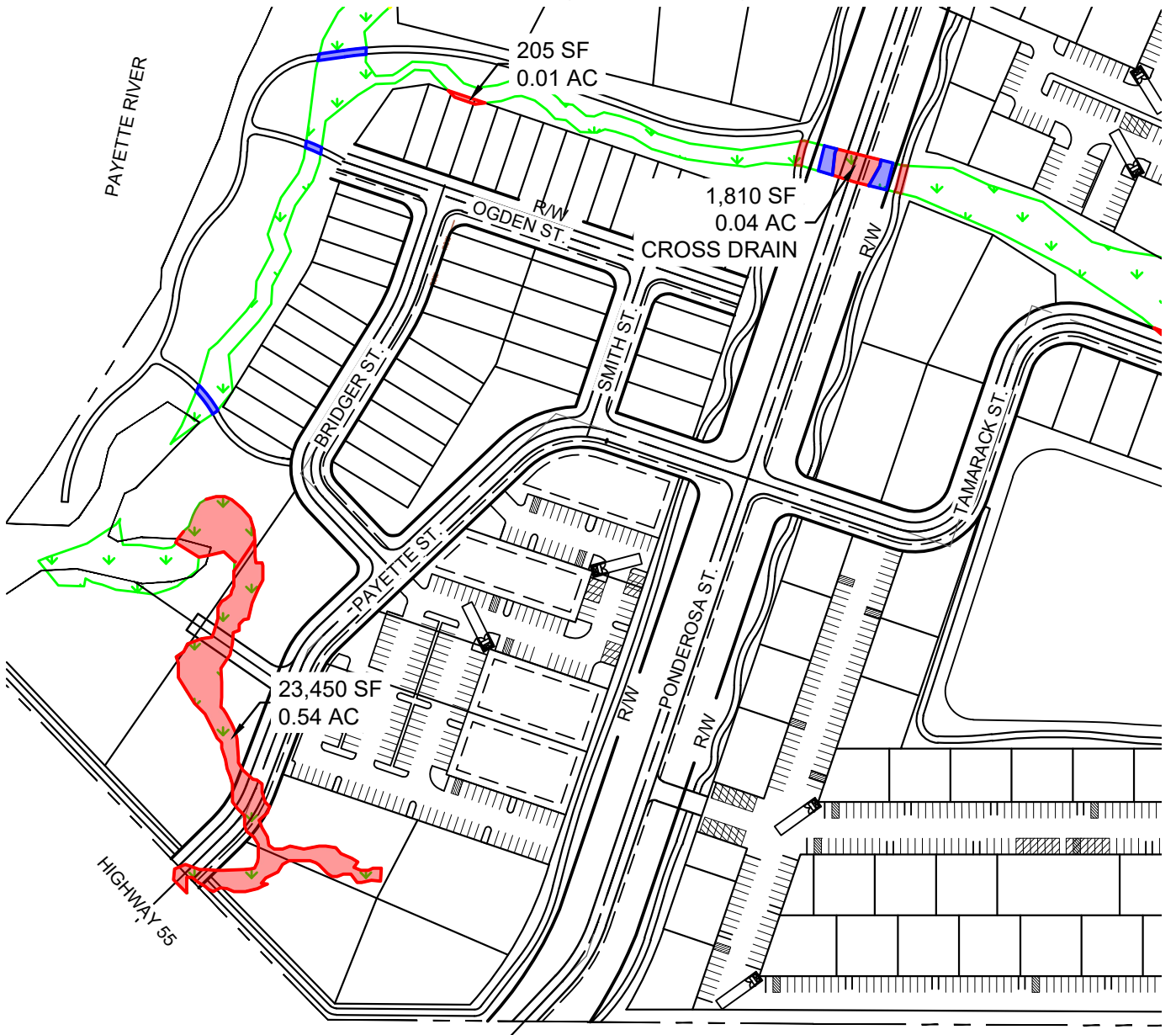

TOTALS AND DISTURBANCES:

PERMANENT 0.60 AC

TEMPORARY 0.05 AC



SCALE: 1" = 200'



T-O ENGINEERS

2471 S. TITANIUM PLACE
MERIDIAN, IDAHO 83642-6703

PHONE: (208) 323-2288

WWW.TO-ENGINEERS.COM

E-FILE: 190100-404 SHEETS.dwg

DATE: 1/6/20

JOB: 190100

THE RIVER DISTRICT
 JOINT APPLICATION
 CASCADE, ID
 PAGE 3 OF 6
PAGE 3 (SE CORNER)

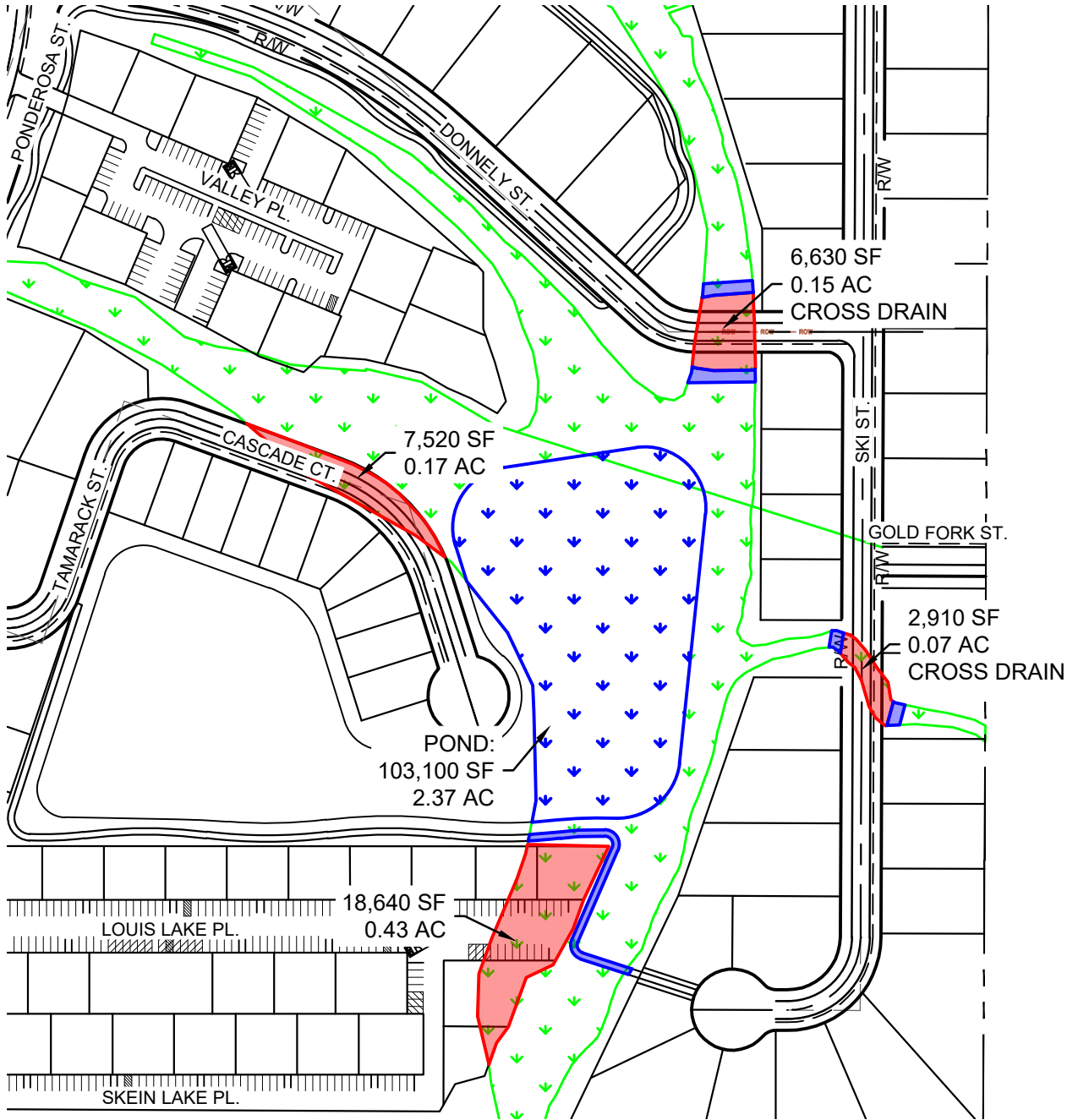

TOTALS AND DISTURBANCES:

PERMANENT	0.82 AC
TEMPORARY	0.13 AC
POND	2.37 AC

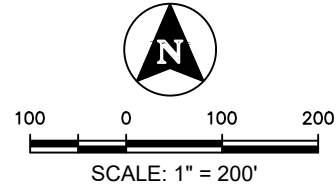

TO T-O ENGINEERS
 2471 S. TITANIUM PLACE
 MERIDIAN, IDAHO 83642-6703
 PHONE: (208) 323-2288 WWW.TO-ENGINEERS.COM
 E-FILE: 190100-404 SHEETS.dwg DATE: 1/6/20 JOB: 190100

H:\1901003_Acaddwg\Sheets\404-PERMIT\190100-404 SHEETS.dwg, 1/6/2020 4:05:22 PM, Aston Carpenter, _DWG To PDF.pc3
 © 2019 T-O ENGINEERS. THIS INSTRUMENT IS THE PROPERTY OF T-O ENGINEERS. ANY REPRODUCTION, REUSE OR MODIFICATION OF THIS INSTRUMENT WITHOUT SPECIFIC WRITTEN PERMISSION OF T-O ENGINEERS IS STRICTLY PROHIBITED.

THE RIVER DISTRICT

JOINT APPLICATION

CASCADE, ID

PAGE 4 OF 6

PAGE 4 (NW CORNER)

H:\1901003_Acaddwg\Sheets\404-PERMIT\190100-404 SHEETS.dwg, 1/6/2020 4:05:27 PM, Aston Carpenter, _DWG To PDF.pc3
 © 2019 T-O ENGINEERS. THIS INSTRUMENT IS THE PROPERTY OF T-O ENGINEERS. ANY REPRODUCTION, REUSE OR MODIFICATION OF THIS INSTRUMENT OR ITS CONTENTS WITHOUT SPECIFIC WRITTEN PERMISSION OF T-O ENGINEERS IS STRICTLY PROHIBITED.

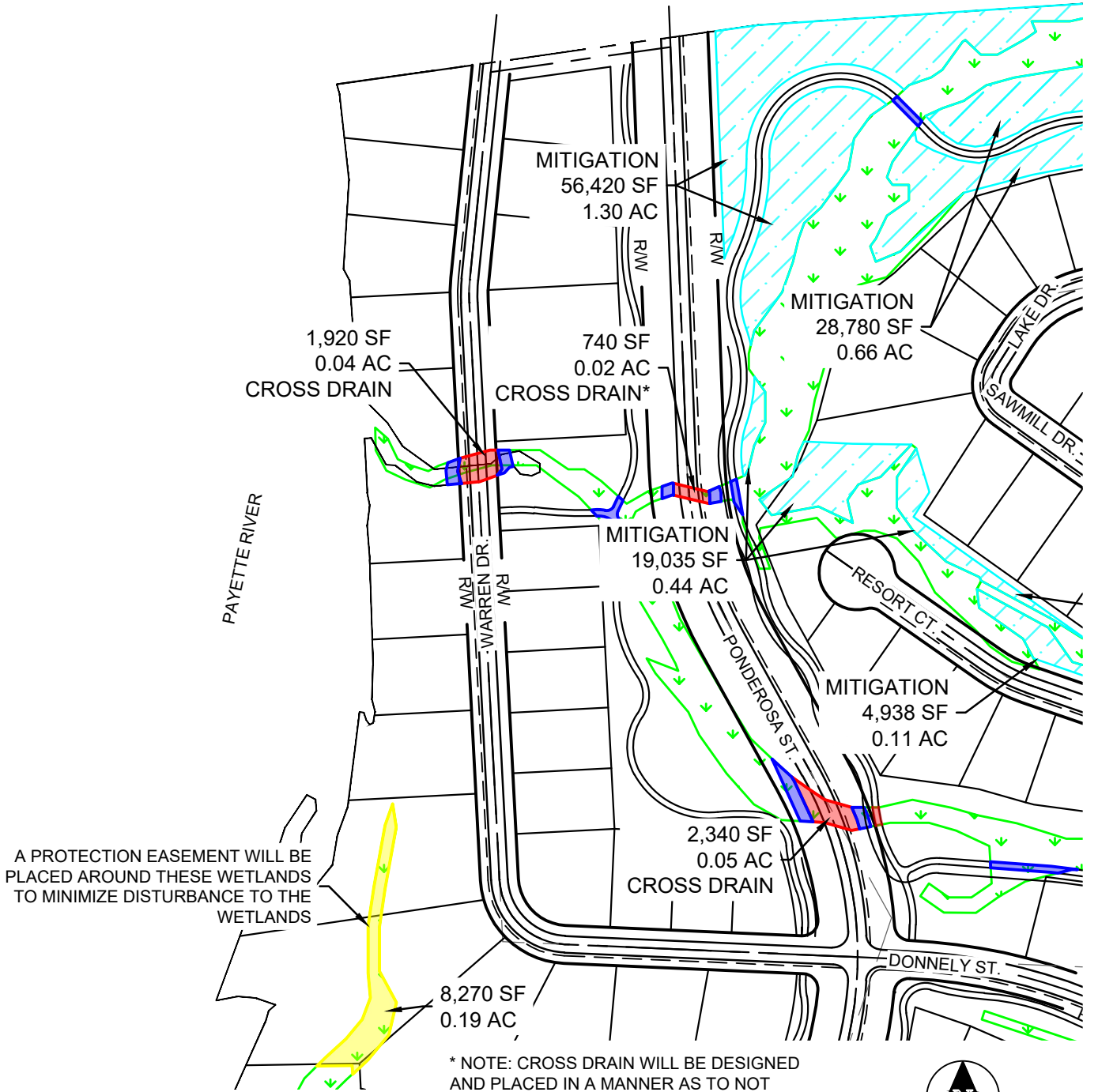

* NOTE: CROSS DRAIN WILL BE DESIGNED AND PLACED IN A MANNER AS TO NOT FACILITATE ADDITIONAL DRAINAGE FROM THE WETLAND MITIGATION AREA. SURFACE WATER RETENTION/PONDING WITHIN THE MITIGATION AREA IS EXPECTED.

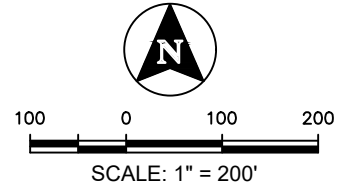

<u>TOTALS AND DISTURBANCES:</u>	
PERMANENT	0.12 AC
TEMPORARY	0.12 AC
MINIMIZED	0.19 AC
POTENTIAL MITIGATION AREA	2.51 AC

T-O ENGINEERS

2471 S. TITANIUM PLACE
MERIDIAN, IDAHO 83642-6703

PHONE: (208) 323-2288 WWW.TO-ENGINEERS.COM

E-FILE: 190100-404 SHEETS.dwg DATE: 1/6/20 JOB: 190100

THE RIVER DISTRICT
 JOINT APPLICATION
 CASCADE, ID
 PAGE 5 OF 6
 PAGE 5 (NE CORNER)

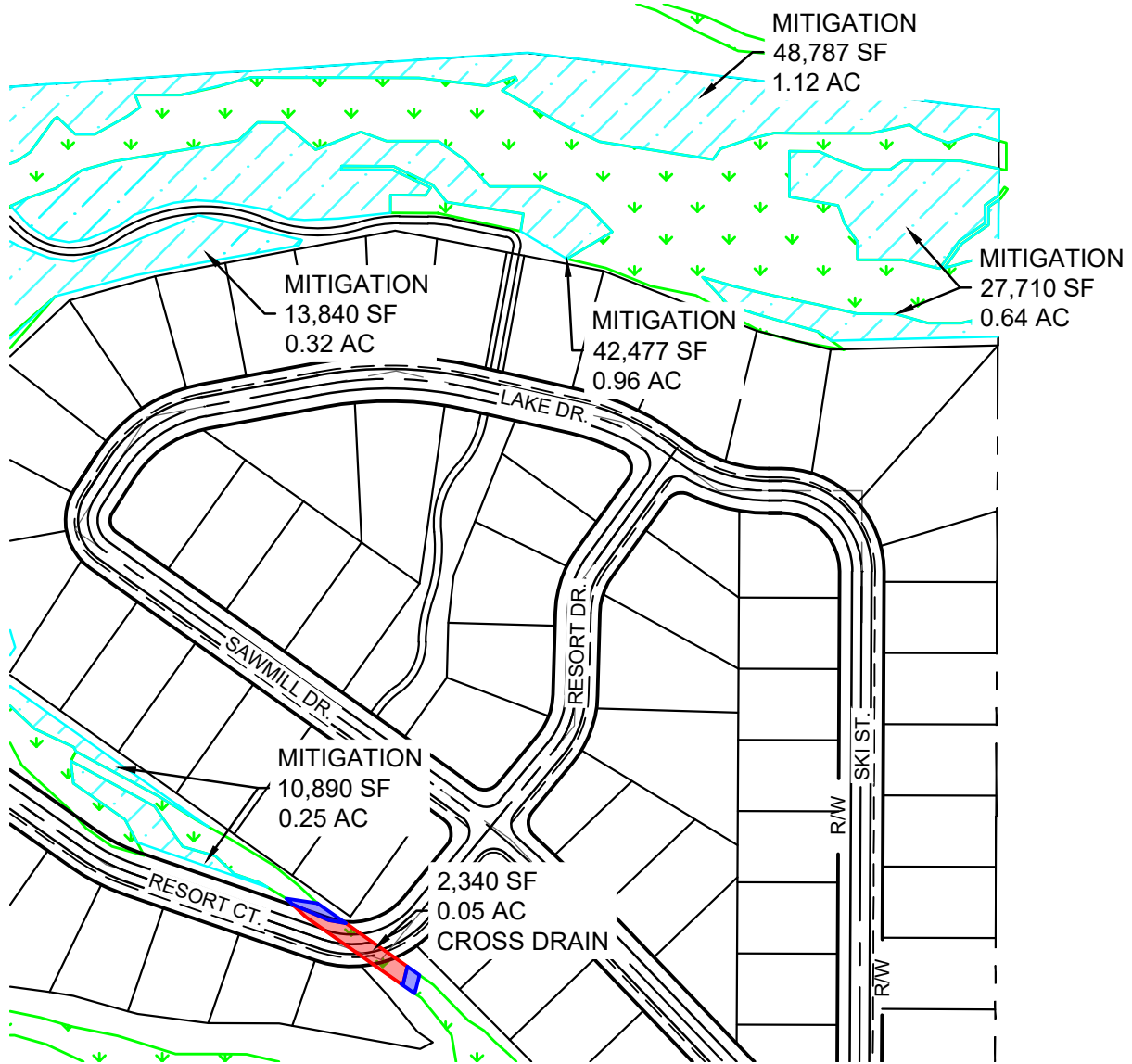

TOTALS AND DISTURBANCES:

PERMANENT	0.05 AC
TEMPORARY	0.02 AC
POTENTIAL MITIGATION AREA	3.29 AC

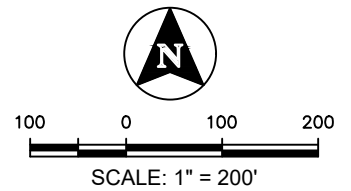

2471 S. TITANIUM PLACE
 MERIDIAN, IDAHO 83642-6703

PHONE: (208) 323-2288

WWW.TO-ENGINEERS.COM

E-FILE: 190100-404 SHEETS.dwg

DATE: 1/6/20

JOB: 190100

H:\190100\3_Acaddwg\Sheets\404-PERMIT\190100-404 SHEETS.dwg, 1/6/2020 4:05:32 PM, Aston Carpenter, _DWG To PDF.pc3
 © 2019 T-O ENGINEERS. THIS INSTRUMENT IS THE PROPERTY OF T-O ENGINEERS. ANY REPRODUCTION, REUSE OR MODIFICATION OF THIS INSTRUMENT OR ITS CONTENTS WITHOUT SPECIFIC WRITTEN PERMISSION OF T-O ENGINEERS IS STRICTLY PROHIBITED.

H:\190100\3_Acad\dwg\Sheets\404-PERMIT\190100-404_SHEETS.dwg, 1/6/2020 4:05:37 PM, Aston Carpenter, _DWG To PDF.pc3
© 2019 T-O ENGINEERS. THIS INSTRUMENT IS THE PROPERTY OF T-O ENGINEERS. ANY REPRODUCTION, REUSE OR MODIFICATION OF THIS INSTRUMENT OR ITS CONTENTS WITHOUT SPECIFIC WRITTEN PERMISSION OF T-O ENGINEERS IS STRICTLY PROHIBITED.

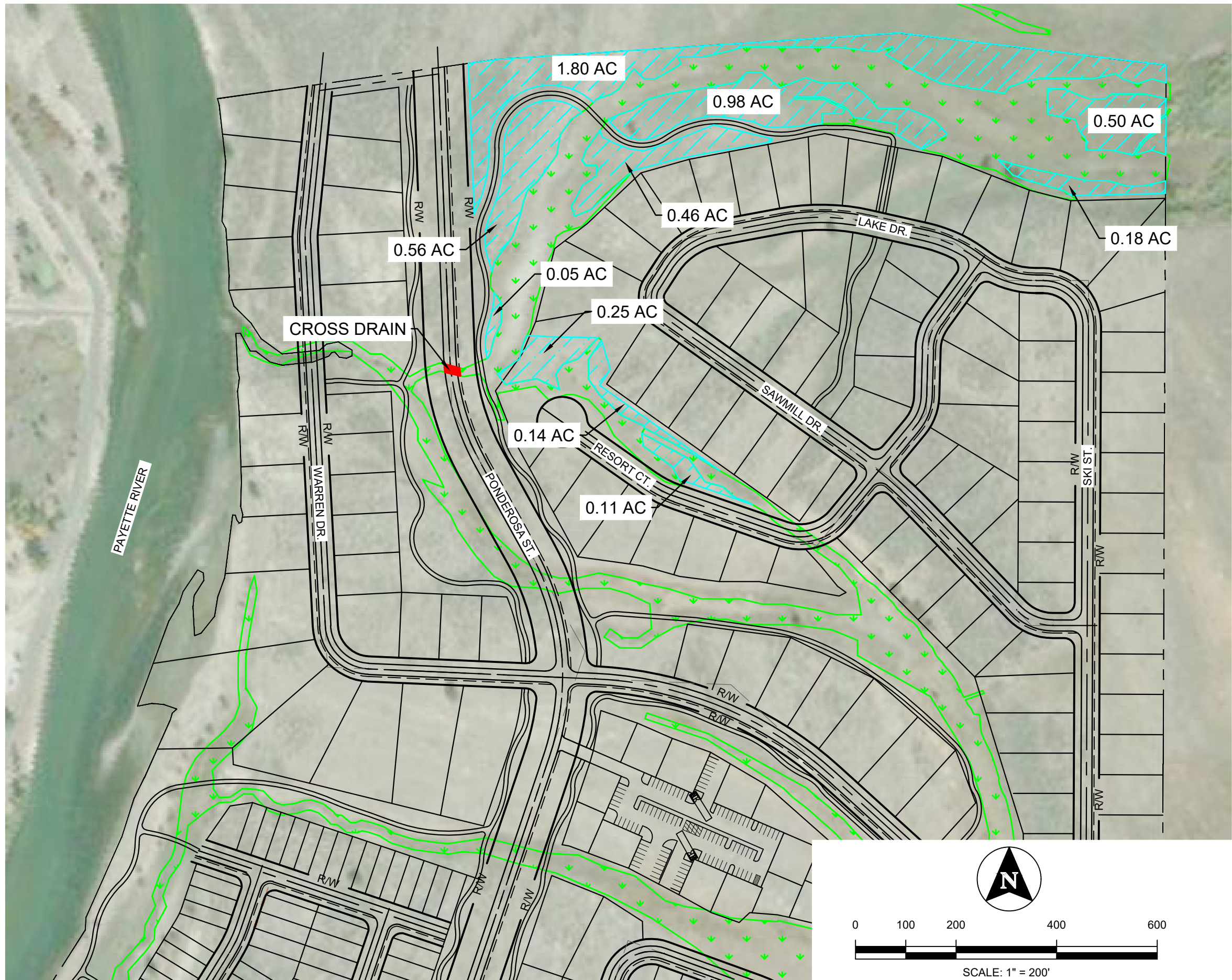

THE RIVER DISTRICT
JOINT APPLICATION
CASCADE, ID
PAGE 6 OF 6
PAGE 6 (MITIGATION AREAS)

NOTES:

POTENTIAL MITIGATION AREA 5.02 AC

- CROSS DRAIN WILL BE DESIGNED AND PLACED IN A MANNER AS TO NOT FACILITATE ADDITIONAL DRAINAGE FROM THE WETLAND MITIGATION AREA. SURFACE WATER RETENTION/PONDING WITHIN THE MITIGATION AREA IS EXPECTED.

LEGEND:

WETLAND 

POTENTIAL MITIGATION AREA 

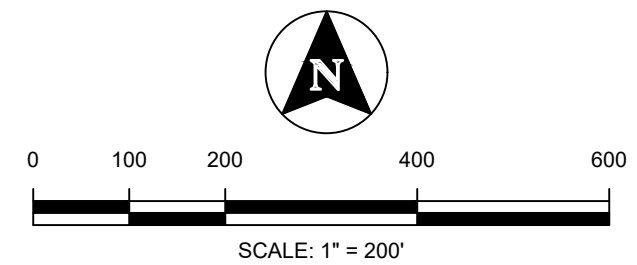

T-O ENGINEERS
2471 S. TITANIUM PLACE
MERIDIAN, IDAHO 83642
PHONE: (208) 323-2288 WWW.TO-ENGINEERS.COM
E-FILE: 190100-404 SHEETS.dwg DATE: 1/6/20 JOB: —